



Application to vary a premises licence under the Licensing Act 2003

PLEASE READ THE FOLLOWING INSTRUCTIONS FIRST

Before completing this form please read the guidance notes at the end of the form. If you are completing this form by hand please write legibly in block capitals. In all cases ensure that your answers are inside the boxes and written in black ink. Use additional sheets if necessary.

You may wish to keep a copy of the completed form for your records.

I/We JAM LEISURE (PARK LANE) LIMITED
(Inset name(s) of applicant)
being the premises licence holder, apply to vary a premises licence under section 34 of the Licensing Act 2003 for the premises described in Part 1 below

Premises licence number
PL0595

Part 1 - Premises Details

Postal address of premises or, if none, ordnance survey map reference or description
PARK LANE
1 TORWOOD STREET
Post town TORQUAY Postcode TQ1 1ED
Telephone number at premises (if any)
Non-domestic rateable value of premises £37750

Part 2 - Applicant details

Daytime contact telephone number
E-mail address (optional)
Current postal address if different from premises address
Post town Postcode

Part 4 Operating Schedule

Please complete those parts of the Operating Schedule below which would be subject to change if this application to vary is successful.

Provision of regulated entertainment

Please tick all that apply

- | | |
|---|-------------------------------------|
| a) plays (if ticking yes, fill in box A) | <input type="checkbox"/> |
| b) films (if ticking yes, fill in box B) | <input type="checkbox"/> |
| c) indoor sporting events (if ticking yes, fill in box C) | <input type="checkbox"/> |
| d) boxing or wrestling entertainment (if ticking yes, fill in box D) | <input type="checkbox"/> |
| e) live music (if ticking yes, fill in box E) | <input type="checkbox"/> |
| f) recorded music (if ticking yes, fill in box F) | <input checked="" type="checkbox"/> |
| g) performances of dance (if ticking yes, fill in box G) | <input checked="" type="checkbox"/> |
| h) anything of a similar description to that falling within (e), (f) or (g) (if ticking yes, fill in box H) | <input checked="" type="checkbox"/> |

Provision of late night refreshment (if ticking yes, fill in box I)

Supply of alcohol (if ticking yes, fill in box J)

In all cases complete boxes K, L and M

Part 3 - Variation

Please tick as appropriate

Do you want the proposed variation to have effect as soon as possible?

Yes

No

If not, from what date do you want the variation to take effect?

| | | |
|----|----|------|
| DD | MM | YYYY |
| | | |

Do you want the proposed variation to have effect in relation to the introduction of the late night levy?

(Please see guidance note 1) Yes

No

Please describe briefly the nature of the proposed variation (Please see guidance note 2)

- CHANGE OF PREMISES LAYOUT
- REMOVAL AND ADDITION OF PREMISES LICENCE CONDITIONS
- TO EXTEND LICENSABLE ACTIVITIES, SUPPLY OF ALCOHOL, RECORDED MUSIC, PERFORMANCES OF DANCE, ENTERTAINMENT OF A SIMILAR DESCRIPTION TO E,F & G FOR PUBLIC HOLIDAYS

If your proposed variation would mean that 5,000 or more people are expected to attend the premises at any one time, please state the number expected to attend:

| | | | |
|---|-------|--------|---|
| Hours premises are open to the public Standard days and timings (please read guidance note 7) | | | State any seasonal variations (please read guidance note 5) On Christmas eve, Boxing day, New Years eve, St Patricks day, St Valentine's day, St Georges day and any Bank Holiday Sunday to extend times for an additional hour |
| Day | Start | Finish | |
| Mon | 10:00 | 03:30 | |
| Tue | 10:00 | 03:30 | |
| Wed | 10:00 | 03:30 | |
| Thur | 10:00 | 03:30 | |
| Fri | 10:00 | 03:30 | |
| Sat | 10:00 | 03:30 | |
| Sun | 10:00 | 03:30 | Non standard timings. Where you intend the premises to be open to the public at different times from those listed in the column on the left, please list (please read guidance note 6) |

Please identify those conditions currently imposed on the licence which you believe could be removed as a consequence of the proposed variation you are seeking.

ANNEXE 2

PREVENTION OF CRIME AND DISORDER

7. There must be no entry/re-entry after 0200 hours.

PREVENTION OF PUBLIC NUISANCE

4. Cooking, noxious or persistent smells from the premises will not cause a nuisance to nearby properties.

5. Provision of mechanical ventilation and air conditioning system shall not allow noise breakout from the premises or cause a nuisance by its operation.

6. Regular maintenance shall be carried out on all plant and machinery to ensure that noise disturbance from such sources is kept to a minimum.

8. There shall be no use of explosives, pyrotechnics and fireworks of a similar nature which could cause disturbance in surrounding areas.

5. Suitable and clearly identifiable areas for dancing must be set aside, and separate from the dance area suitable means of providing cool air/ventilation and adequate seating

must be provided.

6. ✓ Suitable and sufficient sanitary accommodation must be provided, clearly marked and in good order at all times.
7. ✓ No explosive or highly inflammable material shall be brought into the premises.
8. ✓ No pyrotechnics shall be used on the premises.
9. ✓ Lasers must not be used on the premises without consultation with the Licensing Authority and compliance with HS(G) 95.

PUBLIC SAFETY

1. ✓ The fire safety measures with which the premises are provided shall be maintained in good working order, and their adequacy shall be determined on a regular basis by the carrying out of a fire risk assessment as required by and in accordance with the Fire Precautions Regulations.
2. ✓ In the event of evacuation caused by failure of general lighting, the public shall not be readmitted until the general lighting is fully restored.
3. ✓ The premises shall undertake to maintain a safe occupancy level.

PROTECTION OF CHILDREN FROM HARM

- 6.6 ✓ All gaming machines with prizes shall be unplugged and locked.

ANNEXE 3

PREVENTION OF CRIME AND DISORDER

9. ✓ In relation to the consumption of food and drink (alcoholic and non-alcoholic) on the ground floor terrace, there shall be no consumption after 0200 on Friday and Saturday and after 0000 Sunday to Thursday.

PREVENTION OF PUBLIC NUISANCE

17. ✓ After 2300 hours, the number of patrons permitted to use the roof terrace area shall be limited to a maximum of 80 patrons at any one time.

M

Describe any additional steps you intend to take to promote the four licensing objectives as a result of the proposed variation:

a) General – all four licensing objectives (b, c, d and e) (please read guidance note 10)

b) The prevention of crime and disorder

In relation to the consumption of food and drink (alcoholic and non-alcoholic) on the ground floor terrace, there shall be no consumption after 0200.

“There shall be regular use of breathbox(es) and an ID Scanner and a management plan shall be in place detailing how these devices will be used. The premises shall be responsible for the funding of the breathbox(es).”

c) Public safety

d) The prevention of public nuisance

After 2300 hours, the number of patrons permitted to use the roof terrace area shall be limited to a maximum of 100 patrons at any one time.

e) The protection of children from harm

Park Lane

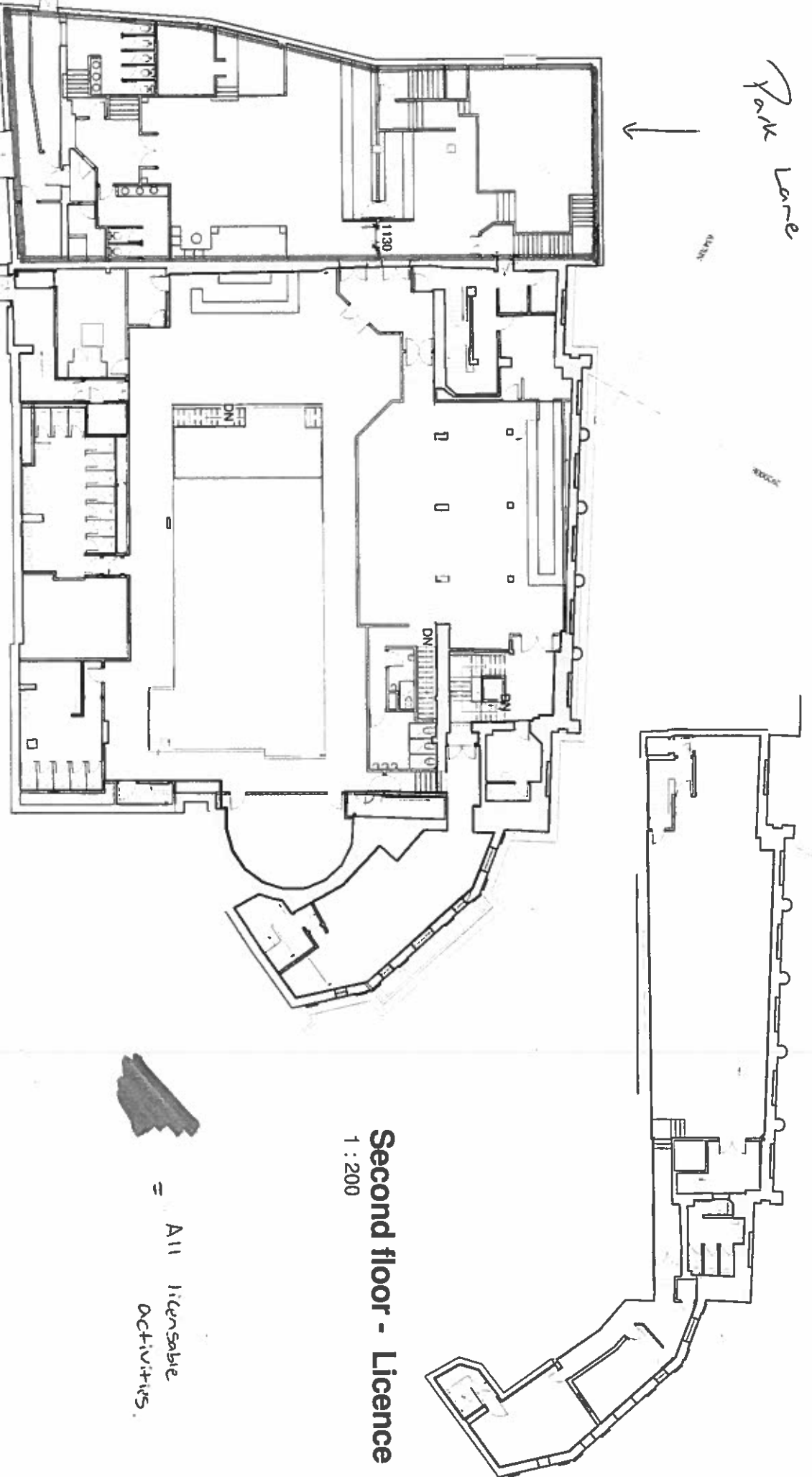

First Floor - Licence

Second floor - Licence

1 : 200

1 : 200

= All licensable activities.

| No. | Description | Date |
|-----|-------------|------|
| | | |
| | | |
| | | |
| | | |
| | | |
| | | |
| | | |
| | | |
| | | |
| | | |

| | | | | |
|---|------|--------|-------------------------|------------------|
| <p>ARCHITECTURAL DESIGN www.jd-architectural.co.uk</p> | CODE | STATUS | SUITABILITY DESCRIPTION | PURPOSE OF ISSUE |
| | | | | |

| | | | |
|--|------------------------------|----------------|-------|
| PROJECT | CLIENT | Mr A Hobbs | |
| Park Lane, Toronto Street 100, 101, 102, 103, 104, 105, 106, 107, 108, 109, 110, 111, 112, 113, 114, 115, 116, 117, 118, 119, 120, 121, 122, 123, 124, 125, 126, 127, 128, 129, 130, 131, 132, 133, 134, 135, 136, 137, 138, 139, 140, 141, 142, 143, 144, 145, 146, 147, 148, 149, 150, 151, 152, 153, 154, 155, 156, 157, 158, 159, 160, 161, 162, 163, 164, 165, 166, 167, 168, 169, 170, 171, 172, 173, 174, 175, 176, 177, 178, 179, 180, 181, 182, 183, 184, 185, 186, 187, 188, 189, 190, 191, 192, 193, 194, 195, 196, 197, 198, 199, 200 Enquiry | Date | 4-1-17 | |
| SHEET | First & second floor licence | Drawn by | JD |
| | | Checked by | PLB |
| | | Project number | 1635 |
| | | DRAWING NUMBER | PL8 |
| | | Scale (@ A3) | 1:200 |
| | | REV | |